

Set up a Basic connection on a Project level in Exalate for Jira Cloud

JIRA CLOUD

Starting from version 5.2.0, not only Global administrators but also Project administrators can set up Basic connections right from the Project settings.

This article shows how to establish a Basic connection specifically on a Project level.

- [How to enable connection set up on a Project level](#)
- [How to initiate a Basic connection from the Project settings](#)

How to enable connection set up on a Project level

A Global administrator should enable connection set up on a Project level.

To enable Project level connections:

1. Go to Apps Manage your apps

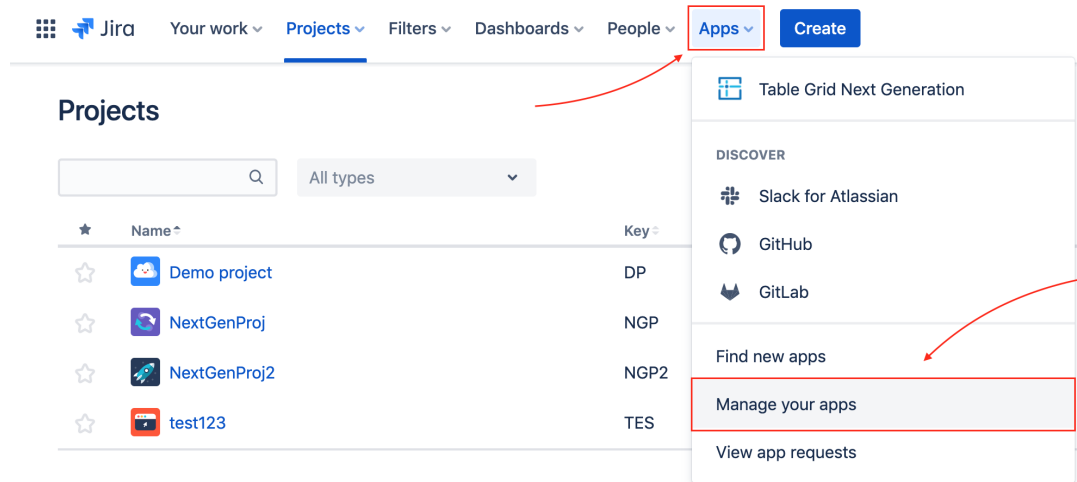

The screenshot shows the Jira navigation bar with the 'Apps' dropdown menu open. The 'Manage your apps' option is highlighted with a red box. A red arrow points from the 'Apps' dropdown to the 'Manage your apps' option. Below the navigation bar, a table of projects is visible:

Name	Key
Demo project	DP
NextGenProj	NGP
NextGenProj2	NGP2
test123	TES

2. Under the Exalate menu click General Settings

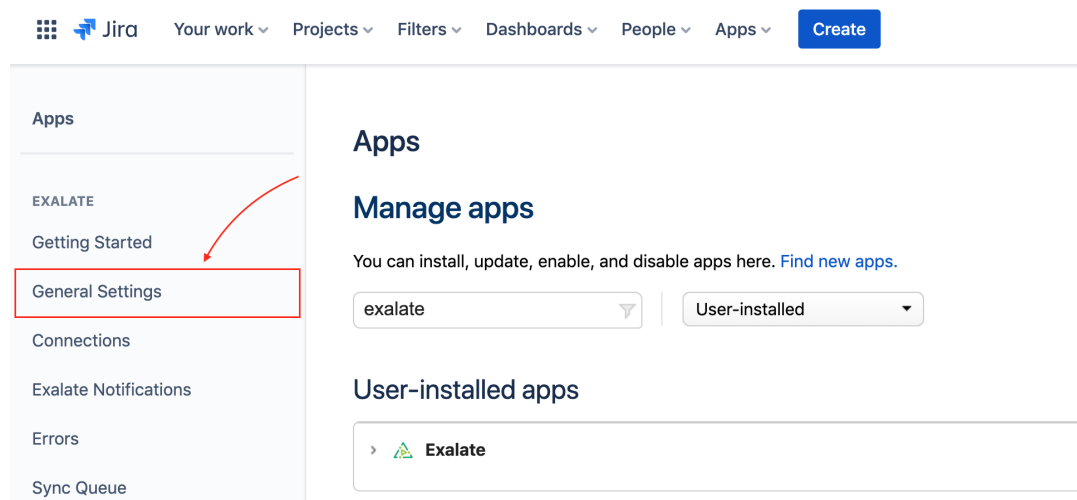

The screenshot shows the Jira 'Apps' page. The left sidebar has 'General Settings' highlighted with a red box. A red arrow points from the 'General Settings' option in the sidebar to the 'Manage apps' section in the main content area. The main content area shows the 'Manage apps' section with a search filter set to 'exalate' and a status filter set to 'User-installed'. Below this, there is a section for 'User-installed apps' with a single entry for 'Exalate'.

3. Enable the corresponding toggle to allow project admins to set up basic connections

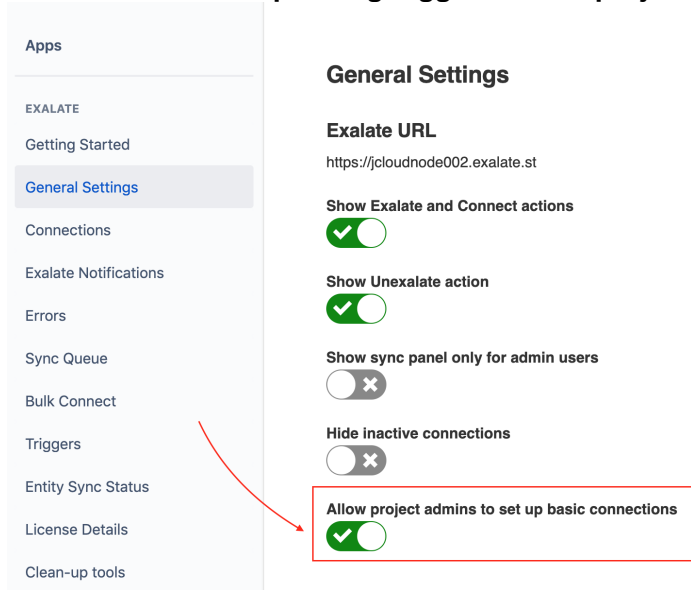

Once global admin enables this option, project admins assigned to the user group **'exalate-project-level-administrators'** will be able to set up basic connections right from their Project settings.

⚠ Note, only project admins that belong to the **'exalate-project-level-administrators'** user group will be able to access Exalate in the Project Settings.

If the **'exalate-project-level-administrators'** group is empty - no project administrators will be able to access Exalate from the Project settings.

If the user group **'exalate-project-level-administrators'** doesn't exist - all the Project admins will be able to access Exalate from their Project settings.

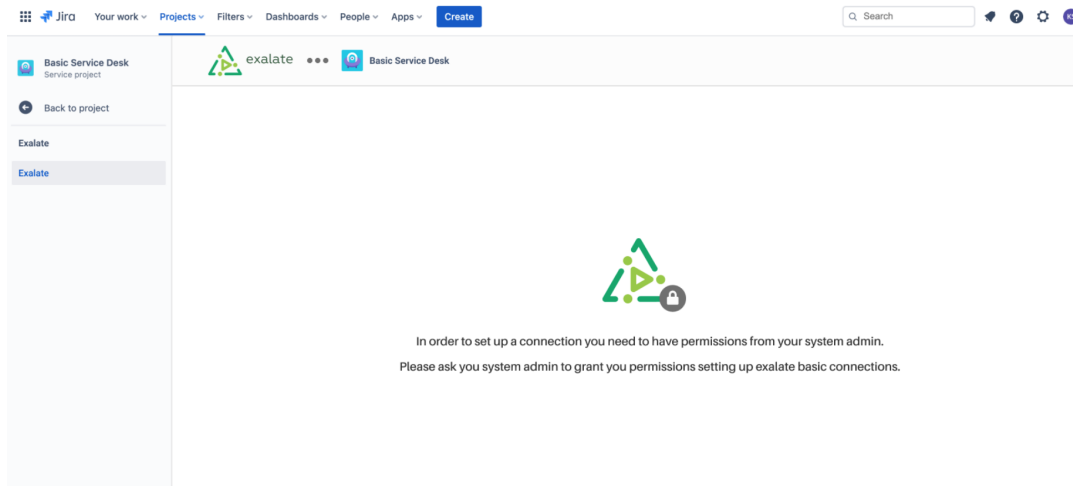

How to initiate a Basic connection from the Project settings

Basic connections have a set of sync rules, generated by Exalate. You can sync a basic set of issue fields: summary, description, comments, attachments, and issue types.

To initiate a Basic connection on a Project level:

1. Navigate to Projects and select your project from the list

2. Click Project settings from the project menu sidebar

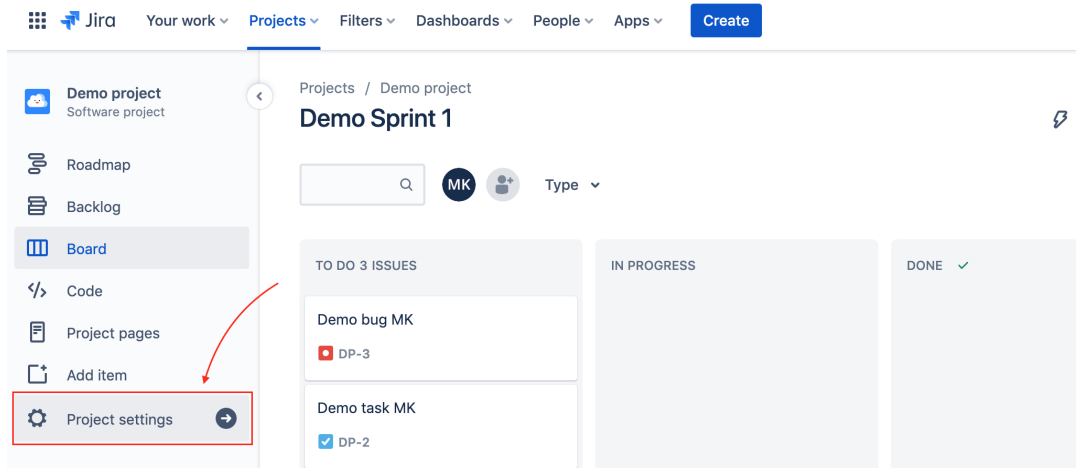

3. Click Apps

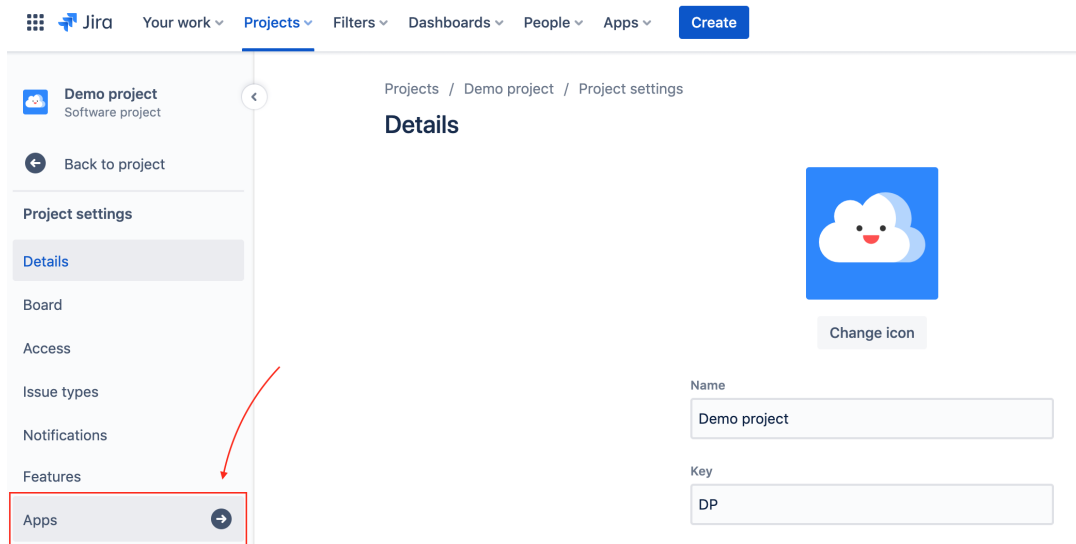

i If you are in a company-managed project, there will be no step 3, Exalate menu will appear right in the **Project settings**.

4. Click Exalate connections Initiate connection

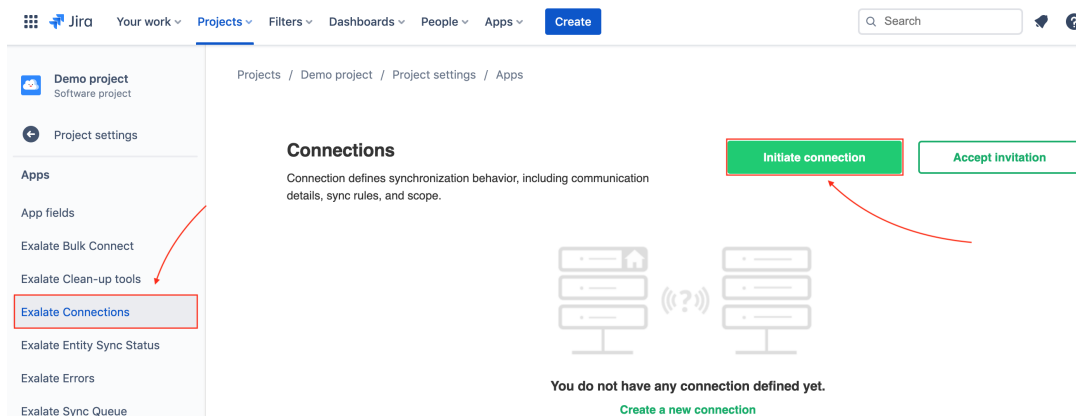

5. Specify if you have the link to the destination instance.

To set up a connection with an instance:

- Enter the link to the destination instance in the **Destination instance URL** field. You can enter the link to the instance you are trying to connect, or the **Exalate URL** from [General Settings](#). If you enter a link to your instance—Exalate will determine it's a [local connection](#) between 2 projects within your instance.

Initiate connection ✕

Destination instance URL ⓘ

[I don't have a URL](#)

[Next](#)

- Click **I don't have a URL** if the destination instance is in a private network, or you don't have the link.

Initiate connection ✕

Destination instance URL ⓘ

[I don't have a URL](#)

[Next](#)

Exalate will suggest available configuration types based on the destination instance's version of Exalate.

i Select the appropriate tab below.

Have more questions? [Ask the community](#)

See also

[Set up a Basic connection in Exalate for Jira Cloud](#)

[Set up a Visual connection in Exalate for Jira Cloud](#)

[Set up a Script connection in Exalate for Jira Cloud](#)

Back to [Set up a connection in Exalate for Jira Cloud](#)